

# QUICK START FlushMinder II Automatic Dual Flush Kit Instructions

This general instruction sheet covers the basic installation procedure for this kit. Since toilet configurations vary widely, your particular installation may require additional steps and/or hardware. For more information, please visit our website at <http://www.water-saver.org> or email your questions to [support@water-saver.org](mailto:support@water-saver.org).



Water Saver Products, LLC

"Home of the FlushSaver DIY Kits"

000 AFM2TA1QS Rev A © WSP 2016

Thank You for choosing Water Saver Products !!!

## OVERVIEW

This electronic dual-flush toilet conversion system fits most standard Flush Handle toilets and is FULLY AUTOMATIC. Upon toilet use, a computerized human-presence Sensor measures the "time-at-the-toilet" and then activates a Flush Motor inside the tank which lifts the flapper valve for either a half-flush (#1) or full-flush (#2) as required. The presence detection is self-calibrating and the half and full flush cycles are programmable with a simple Magnetic Wand and Flapper Chain (both included). The Sensor and Flush Motor installation and setup are quick and easy with minimal tools, NO TANK REMOVAL or plumbing skills required. Both Sensor and Flush Motor are moisture sealed and run on 6 standard AA alkaline batteries (included) for up to 1 year or 10,000 worry-free flushes. Saves water and improves sanitation - perfect for children, the elderly, public toilets or any high-use bathroom area where flushing delinquency is a problem.

## PREPARATION

Before attempting installation, please read these Quick Start Instructions thoroughly, familiarize yourself with your specific toilet configuration and gather any required tools. Ensure that the Sensor can be mounted just above the toilet tank with no frontal obstructions within a range of 4 ¼ feet and that the Flush Motor will fit down inside the toilet tank roughly above the flapper valve without interference. The battery compartment inside the Sensor requires a small Philips screwdriver to open since the cover is tightly sealed against moisture with a silicon gasket. The Sensor unit itself can be mounted with either its attached double-sided tape or by using the included wall fasteners or other similar fasteners as desired, so a drill and appropriate bit may be required as well.

## COMPONENTS

(Objects not to relative scale for clarity)

### DETECTION EYE

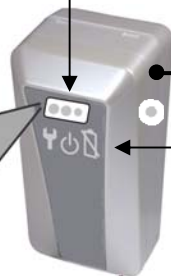

SENSOR

MAGNETIC TARGET

LED INDICATORS

DETECTION BEAM



FLUSH CYCLE  
SETUP MODE

PRESENCE  
DETECTION

LOW BATTERIES

FLUSH  
MOTOR

FLUSH HANDLE  
(Remains Functional)

FLUSH HANDLE  
LEVER ARM

FLUSH MOTOR  
BEAD CHAIN

FLUSH MOTOR  
LEVER ARM

## ACCESSORIES

(Objects not to relative scale for clarity)

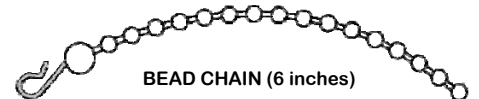

BEAD CHAIN (6 inches)



MAGNETIC WAND



MOTOR MOUNT



MOUNT COLLARS  
(2 SIZES - OPTIONAL)



AA BATTERIES (6)



WALL MOUNT SET  
(OPTIONAL)

INSTALLATION (over)



# INSTALLATION

## 1

Position the Sensor on the wall behind the tank such that it is high enough to "see" above any obstacles, yet low enough to detect a person sitting on the toilet.



TAPE MOUNT - or - SCREW MOUNT

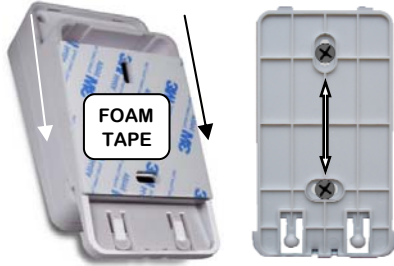

Mount the Sensor using the attached foam tape on the back plate or remove the back plate by sliding downward and mount using the appropriate wall anchors, then place the Sensor back on the wall.

⇒ DO NOT INSTALL BATTERIES YET !!! SLIDE OFF

## 2

Unclip and fit the motor mount (A) onto the bowl fill tube (C) using one of the mount collars (B) if required.

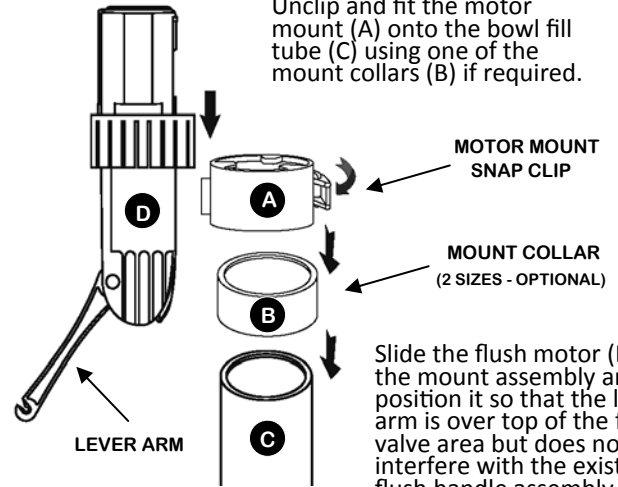

Slide the flush motor (D) onto the mount assembly and position it so that the lever arm is over top of the flapper valve area but does not interfere with the existing flush handle assembly.

## 3

Clip the lower end of the bead chain to the top of the flapper valve (A) at the same attach point as the existing lever handle chain.

Now snap the upper end of the bead chain into the lever arm groove (B), leaving a little slack in the chain.

Check the relative alignment of both lever arms and chains to ensure there is no interference, adjust as necessary, then secure the motor mount snap clip.

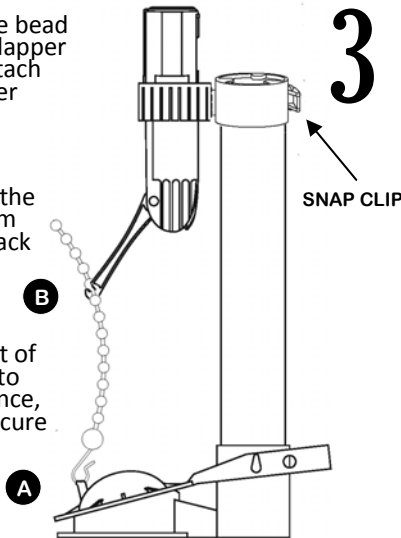

## 4

Remove the Sensor from its wall plate by sliding upward and off, then remove the battery cover with a small Philips screwdriver. Install the 6 AA batteries and immediately hold the unit back against its mount while standing to the side (out of the detection beam) until the Presence Detection LED stops flashing.

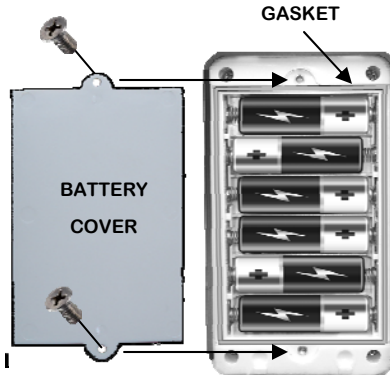

Now check that the silicone gasket inside the battery compartment is in position, replace the battery cover and then reinstall the Sensor unit back onto its wall mount.

⇒ FLUSH MOTOR MAY CYCLE ANYTIME DURING THIS STEP

# ADJUSTMENTS

## 5



Adjust the Half Flush cycle time by holding the Magnetic Wand against the right side Magnetic Target until the desired water release is achieved. Note the speed and distance of the Flush Motor up/down cycle and adjust accordingly. The Full Flush cycle will be set automatically in relation to the Half Flush cycle.

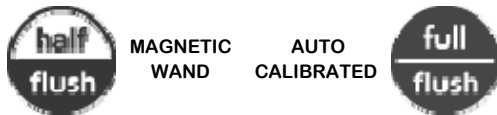

⇒ FLAPPER VALVE SHOULD NOT FULLY OPEN ON EITHER CYCLE

# TESTING

## 6

Stand in front of the Sensor until the Detection LED flashes for about 15 secs and then step aside to activate a test Half Flush. Observe the mechanics and alignment of the Flush Motor as it cycles and make any further adjustments.



Also ensure that the Flush Handle can still be operated normally without interference so that the toilet can still be flushed normally as before.

## INSTALLATION AND SETUP COMPLETE!

**NOTE:** Anytime the batteries are replaced or the Sensor range needs to be recalibrated, simply repeat steps 5 & 6. To prevent false detection and random flushes, keep any obstacles or mirrored surfaces out of the Detection Beam.

### SPECIFICATIONS

Sensor: 4.75Lx2.75Wx2.55D inches (120x70x65 mm)  
 Detection Range: 0 - 31.5 +/- 4.0 inches (80 +/- 10 cm)  
 Detection Clearance: 51 inches (130 cm)  
 Flush Motor: Servo Jackscrew (stall protected)

Half Flush Timer: 10 - 60 secs  
 Full Flush Timer: > 60 secs  
 Maximum Flush Cycle: 10 secs  
 Autoflush: 1 per week

Power: 6 AA Batteries  
 Type: Alkaline, Lithium, Rechargeable Lithium  
 Protection: Moisture Sealed  
 Life: 1 Year or 10,000 flushes (approximate)